

## Heavy Duty Housing Seal Upgrade

EPC developed the IP-65 rated sealing option for the Heavy Duty style housings for demanding and harsh environments. The HD12 and HD14 offer superior sealing when compared to the HD2 and HD4, respectively, with the improved IP-65 seal. The performance of the seal has proven so successful that we now have plans to make it the only sealing option for the Heavy Duty housings. Therefore the EPC will discontinue the HD2 and HD4 housings as a standard catalog item.

The price for the higher performance IP-65 seal used with the HD12 and HD14 will remain the same as the previous seal used on the HD2 and HD4.

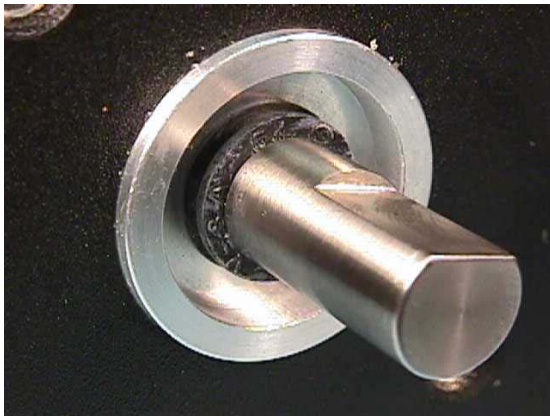

*HD2, HD4 Seal*

### Sealing Differences

The HD2 and HD4 incorporate a resilient rubber seal and the HD12 and HD14 use a tough, low wear Teflon based seal. The rubber seal is considered protection for dust and light moisture but does not carry an industrial rating. The Teflon seal is dust tight and protects against multidirectional water jet sprays and does carry an industrial rating of IP-65.

### Torque Differences

As with any shaft seal, the seal contacting the shaft increases the starting torque. Torque differences between the two seals are so slight they should be considered interchangeable in any application.

### Part Number Changes

The complete unit part numbers remain the same with the exception that the HD2 now should be replaced with HD12 and HD4 should be replaced with HD14. EPC Customer Service will be pleased to

assist customers converting HD2 and HD4 part numbers to HD12 and HD14.



*HD12, HD14 Seal*

### Dimensional Differences

The HD2 and HD4 have a .969 inch boss, and the HD12 and HD14 have a 1.000 inch boss around the unit shaft. Therefore applications using this boss for alignment, or applications using shaft side mounting may require additional clearance for this boss. For applications which require the .969 inch boss and modifications cannot be made, please contact the EPC factory @ 800-366-5412.

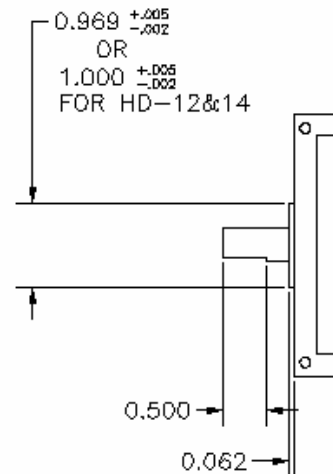

*Drawing of Boss Dimensions*

If you have questions regarding this Technical Bulletin, please call Technical Support at (800) 366-5412 or email [techsupport@encoder.com](mailto:techsupport@encoder.com).

TB-113.doc, Rev B, 09/05/30